

ELECTRIC PRESSURE COOKER

USER MANUAL

MY-CS6037WP2

Warning notices: Before using this product, please read this manual carefully and keep it for future reference. The design and specifications are subject to change without prior notice for product improvement. Consult with your dealer or manufacturer for details. The diagram above is just for reference. Please take the appearance of the actual product as the standard.

THANK YOU LETTER

Thank you for choosing Midea! Before using your new Midea product, please read this manual thoroughly to ensure that you know how to operate the features and functions that your new appliance offers in a safe way.

CONTENTS

THANK YOU LETTER	01
SAFETY INSTRUCTIONS	02
SPECIFICATIONS	06
PRODUCT OVERVIEW	07
QUICK START GUIDE	08
OPERATION INSTRUCTIONS	12
CLEANING AND MAINTENANCE	14
TROUBLESHOOTING	21
TRADEMARKS, COPYRIGHTS AND LEGAL STATEMENT	23
DISPOSAL AND RECYCLING	24
DATA PROTECTION NOTICE	25

SAFETY INSTRUCTIONS

Intended Use

The following safety guidelines are intended to prevent unforeseen risks or damage from unsafe or incorrect operation of the appliance. Please check the packaging and appliance on arrival to make sure everything is intact to ensure safe operation. If you find any damage, please contact the retailer or dealer. Please note modifications or alterations to the appliance are not allowed for your safety concern. Unintended use may cause hazards and loss of warranty claims.

Explanation of Symbols



Danger

This symbol indicates that there are dangers to the life and health of persons due to extremely flammable gas.



Warning of electrical voltage

This symbol indicates that there is a danger to life and health of persons due to voltage.



Warning

The signal word indicates a hazard with a medium level of risk which, if not avoided, may result in death or serious injury.



Caution

The signal word indicates a hazard with a low degree of risk which, if not avoided, may result in minor or moderate injury.



Attention

The signal word indicates important information (e.g. damage to property), but not danger.



Observe instructions

This symbol indicates that a service technician should only operate and maintain this appliance in accordance with the operating instructions.

Read these operating instructions carefully and attentively before using/commissioning the unit and keep them in the immediate vicinity of the installation site or unit for later use!

⚠ Warning

- Read all the instructions.
- This appliance is for household use only. Do not use outdoors.
- This appliance is not intended for use by persons with reduced physical, sensory or mental capabilities, or lack of experience and knowledge, unless they have been given supervision or instruction concerning use of the appliance by a person responsible for their safety.
- This appliance shall not be used by children. Keep the appliance and its cord out of reach of children.
- Children should be supervised to ensure that they do not play with the appliance.
- This appliance is intended to be used in household and similar applications such as:
 - Staff kitchen areas in shops, office and other working environments.
 - Farm houses.
 - By clients in hotels, motels and other residential type environments.
 - Bed and breakfast type environments.
- Do not immerse any part of the appliance in water or other liquid.
- The pressure regulator allowing the escape of steam should be checked regularly to ensure that they are not blocked.
- The container must not be opened until the pressure has decreased sufficiently.
- The heating element surface is subject to residual heat after use, do not touch.
- Warning: Avoid spillage on the connector.
- Warning: Misuse may cause potential injury.
- Do not put the pressure cooker into a heated oven.

- Move the pressure cooker under pressure with the greatest care. Do not touch hot surfaces. Use the handles and knobs. If necessary, use protection.
- Do not let children near the pressure cooker when in use.
- Do not use the pressure cooker for a purpose other than the one for which it is intended.
- This appliance cooks under pressure. Scalds may result from inappropriate use of the pressure cooker. Make sure that the cooker is properly closed before applying heat, see “instructions for use”.
- Never force open the pressure cooker. Do not open before making sure that its internal pressure has completely dropped. See the “instructions for use”.
- Never use your pressure cooker without adding water or food, this would seriously damage it.
- Use the appropriate heat source(s) according to the instructions for use.
- After cooking meat with a skin (e.g. ox tongue) which may swell under the effect of pressure, do not prick the meat which the skin is swollen; you might be scalded.
- When cooking doughy food, gently shake the cooker before opening the lid to avoid food ejection.
- Before each use, check that the valves are not obstructed. See the instructions for use.
- KEEP THESE INSTRUCTIONS.

Caution

- Please turn off and unplug the appliance before cleaning, maintenance or relocation and whenever it is not in use.
- Do not fill the cooker beyond 2/3 of its capacity. When cooking foodstuffs which expand during cooking, such as rice or dehydrate vegetables, do not fill the cooker to more than half of its capacity.
- Never use the pressure cooker in its pressurized mode for deep or shallow frying of food.

Observe instructions

- If the supply cord is damaged, it must be replaced by the manufacturer, its service agent or similarly qualified persons in order to avoid a hazard.
- The appliance is not intended to be operated by means of an external timer or a separate remote-control system.
- Do not tamper with any of the safety systems beyond the maintenance instructions specified in the instructions for use.
- Only use manufacturer's spare parts in accordance with the relevant model. In particular, use a body and a lid from the same manufacturer indicated as being compatible.

SPECIFICATIONS

Product Model	MY-CS6037WP2
Capacity	6 L
Power Supply	220-240V~ 50/60Hz
Rated Power	1000W
Size of Inner Pot	8.66"
Working Pressure	60kPa
Keep Warm Temperature	140° F-176° F

PRODUCT OVERVIEW

Product Structure

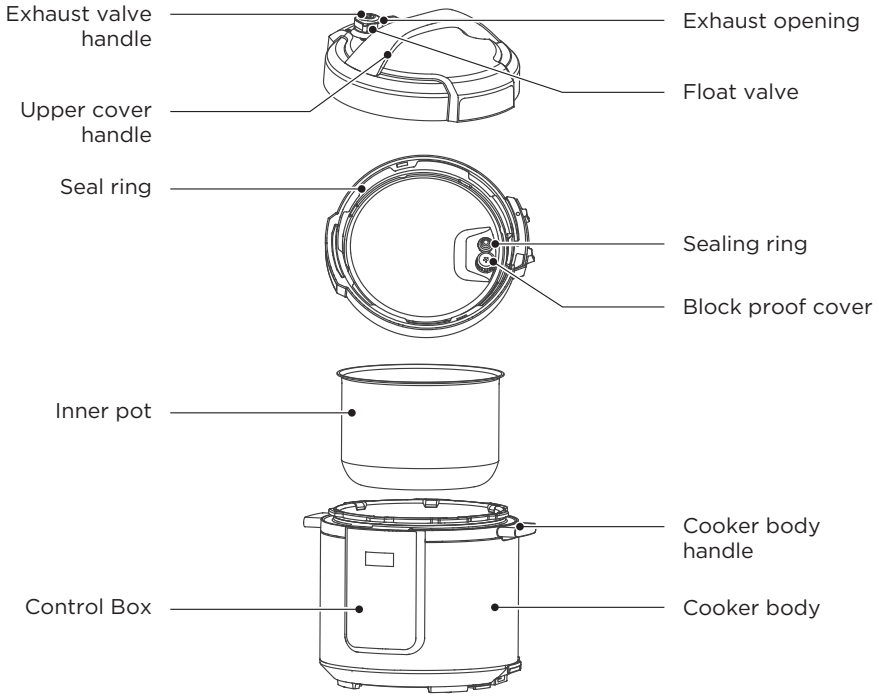

Parts List



Spoon

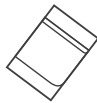

User Manual

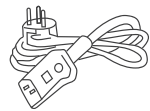

Power Cord Components

NOTE

All the pictures in this manual are for explanation purpose only. Any discrepancy between the real object and the illustration in the drawing shall be subject to the real subject.

QUICK START GUIDE

Tips:

1. Please move the product with the handle of the cooker body;
2. Please remove the water from the housing cover with cloth.

NOTE

- Exhaust valve: Pull out the exhaust valve from the lid. Clean the internal side of the exhaust valve and the exhaust valve and float valve of the lid with brush and cloth at least once a month.
- Sealing ring: Please remove oil and dirt from the sealing ring with detergent and brush.
- Water box: After cooking, the steam may stay in the water box of the external pot as water. Water in the box should be removed for avoiding bad odor, please clean it with clean cloth.

Disassemble And Install The Block Proof Cover And Seal Ring

Disassemble and install the block proof cover

1. Check if the seal ring and block proof cover are correctly installed in the upper cover before use each time.
2. After use, please clean the seal ring and around of block proof cover for avoiding jamming the cover, keep it clean to avoid bad odor.

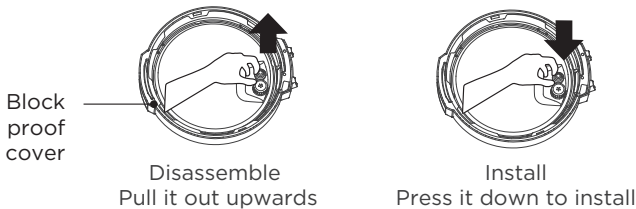

Disassemble and install the seal ring

1. Please do not pull the seal ring, otherwise, the distorted seal ring may influence the seal and pressure effect.
2. Do not use the dam aged seal ring, please replace it at the autho rized repair office.

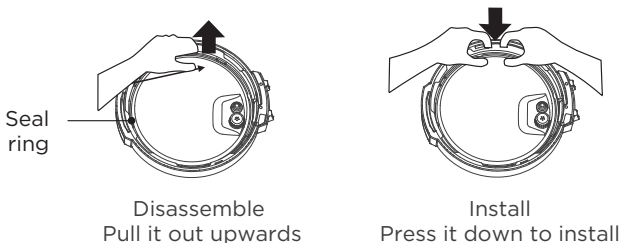

Use And Maintain The Inner Pot

1. Do not empty

It may cause yellowish and spotted inner pot or distorted bottom if it is empty for a long time.

2. Do not use it to store the acid, alkali and preserved foods for a long period

Although the inner pot has excellent anti-corrosion performance, it may cause corrosion of certain degree, the suggested time of keep warm shall not exceed 2h.

3. Keep it clean to prolong the service life

Do not immerse it in water for a long period.

Clean the inner pot with soap, mild detergent or warm water to remove dust, oil and dirt.

4. Do not use a metal shovel or other hard tool, otherwise it will damage the inner surface of pot.

Prepare For Cooking

1 Opening the lid correctly

- Hold the handle of upper cover, turn it anticlockwise for about 30° till the lid at unlock state, and then lift the upper cover.

2 Check if the parts and accessories of lid are well installed

- Check if the floater valve and exhaust valve are jammed, confirm if the sealing ring and block proof cover are well installed.

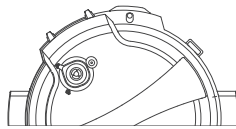

Unlock State

3 Take out the inner pot, put the foods and water into the inner pot

- The total amount of foods and water shall not exceed the Max marked on the inner pot.

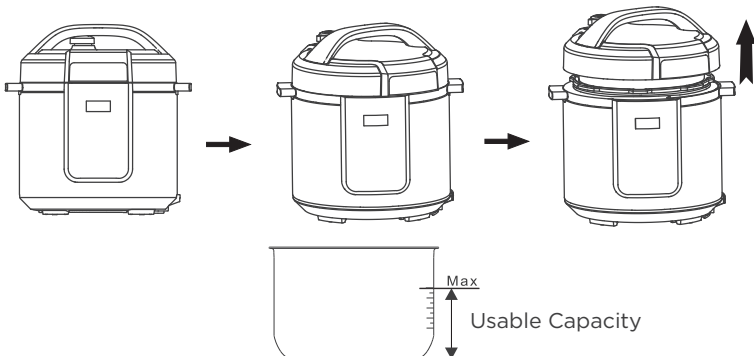

4 Put the inner pot into the cooker

- Wipe to clean the external surface of inner pot, foreign object and water are not allowed on the inner surface of electric pressure cooker;
- Turn the inner pot to left and right to ensure good contact with the heating plate.

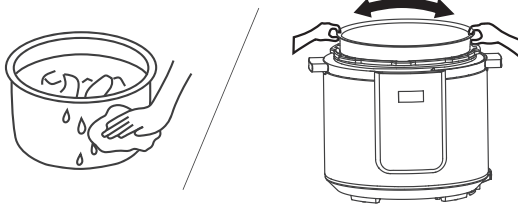

5 Safely close the lid

- Before closing the lid, check if the sealing ring is well installed.
- Hold the handle of upper cover, aim the lid as “unlock state”, put the top cover horizontally on the cooker body, turn the upper cover clockwise for about 30° to the lock place as “Lock State”.

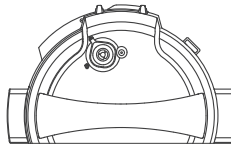

Lock State

6 Put the exhaust valve well

- When working, please turn the exhaust valve to the sealing place, which means the electric pressure cooker keeps at sealing state;
- For manual exhaust, please turn the exhaust valve handle to the exhaust place, the electric pressure cooker keeps at the exhaust state; when exhausting, do not keep the hands or face above the exhaust opening;

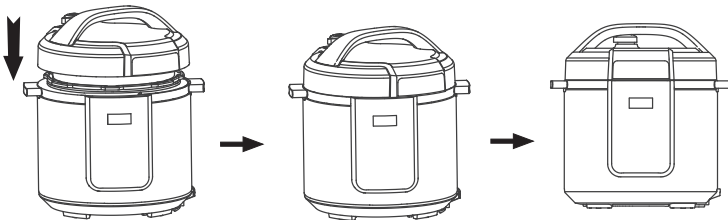

NOTE

- (Picture are for reference only, atual product may differ from picture shown)

- Check if the floater valve drops down before working (before heating, the floater valve is down).



Sealing schematic diagram

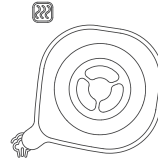

Exhaust schematic diagram

General Function

1. Switch on If the buttons are inactive when use, please confirm if the lid is closed at the right place, the buttons are inactive if the lid is not closed correctly for product of this series.
2. After cooking, the cooker may automatically enter into the keep warm state. After cooking, the cooker may automatically enter into the keep warm state(Some funtion). and the indicator display "0H(0 hour), 1H(1 hour), 2H(2 hour)... "or " LO:00(0 min), LO:01(1 min)...."

🔊 Tips:

When the cooker is working, it is normal that it makes "cluck" sound, please set your heart at relax when use.

To cook a small amount of foods, the inner pot may possibly be lifted when opening the lid, please shake the lid to drop the inner pot in the cooker body and then remove the lid.

Safely Open The Lid

1. Cut off power supply or remove the power plug
2. Exhaust method
 - A. Quickly open the lid (For non-fluid foods)
Turn the exhaust valve to the exhaust place for exhausting, Some unit by pressing steam release button "🔊" till the float valve drops down.
 - B. Generally open the lid
Keep the electric pressure cooker cool naturally till the float valve drops down.
3. Open the lid
Turn the upper cover anticlockwise with the left hand, turn it to the cover open limit place, lift the upper cover with the right hand to open the lid.
Do not open the lid before the pressure in the pot has been completely released, do not open the lid fiercely if it is difficult to open.
Do not pull out the exhaust valve when turning the exhaust valve.
After cooking fluid foods (porridge and soup), do not turn the exhaust valve or press the steam release button please cut off power supply to make it cool naturally till the float drops before opening the lid.

OPERATION INSTRUCTIONS

Operation Part

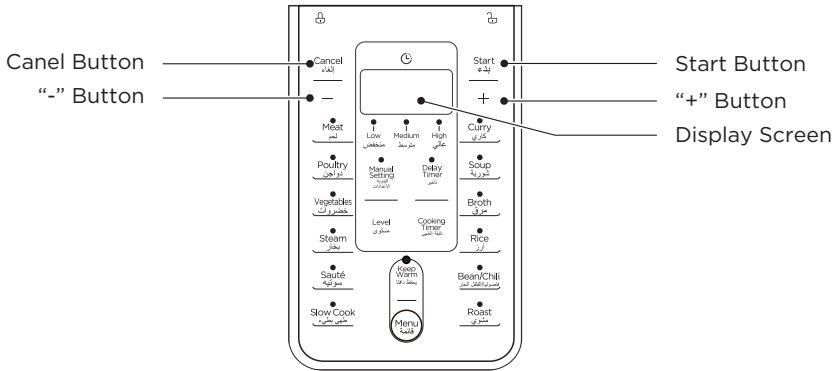

Operation Guidelines

Function	Operation Guidelines
Cancel	<ul style="list-style-type: none"> Under any state, pree "Cancel" button to cancel the current work state and return stanby state.
Keep Warm	<ul style="list-style-type: none"> Under standby state, pree "Keep Warm" button, the indicator light is on and the digital screen shows default working time. Press "Cooking Timer" button, then press "+" or "-" button to into keep warm state. "Keep Warm" indicator light is on and the digital screen shows default working time. Press "+" or "-" button to adjust the working time.
Sauté	<ul style="list-style-type: none"> Under standby state, press "Menu" button, the indicator light is on and the digital screen shows default working time. Press "Start" button to enter into cooking sate. Starts countdown and enters to standby sate when it finishes working.
Roast	<ul style="list-style-type: none"> Under standby state, press "Menu" button, the indicator light is on and the digital screen shows default working time. Press "Cooking Timer" button, then prss "+" or "-" button to adjust the working time. Press "Start" button to enter into cooking sate. The digital screen starts countdown as soon as the temperature rise to working temperature. Enters into keep warm when it finishes working.

Function	Operation Guidelines
Slow Cook	<ul style="list-style-type: none"> • Under standby state, press the function button, the indicator light is on and the digital screen shows default working time. • Press “Cooking Timer” button, then press “+” or “-” button to adjust the working time. Press “Start” button to enter into cooking state. • The digital screen starts countdown and the unit enters to keep warm when it finishes working.
Meat Curry Soup Broth Steam Vegetables Poultry Bean/Chili Rice Manual Setting	<ul style="list-style-type: none"> • Under standby state, prss “Menu” button, the indicator light is on and the digital screen shows default working time. Press “Cooking Timer” button, then press “+” or “-” button to adjust the working time. Press “Start” button to enter into cooking state. • The digital screen starts countdown as soon as the pressure rise to working pressure. Enters into keep warm when it finishes working.
Delay Timer	<ul style="list-style-type: none"> • Delay cooking: Before the program start, press “Delay Timer” button. The screen shows the preset beginning time. Press “Cooking Timer” button, the press “+” or “-” button to adjust the delay time. Then press “Delay Timer” button to change Hour and minute. Press “Start” button, the unit starts delay time countdown. When it countdown to the end, the program starts working. Note: Sauté、Roast、Keep Warm function cannot set the delay timer.
Level	<ul style="list-style-type: none"> • Before the program start, you can press “Level” button to change to the food flavor for “Low” or “Medium” or “High”.

CLEANING AND MAINTENANCE









For use the product safely with a longer service life, please carefully check and maintain it.

If followings occur	Solutions
<ul style="list-style-type: none">• Power cord and plug is expanded, deformation, damaged and it color is changed.• One part of the power cord and plug are hotter.• Power cord is flexible with discontinuous power supply.• The electric pressure cooker has abnormal heating and generates bad odor.• There's abnormal noise or vibration when supply power.	Stop using, and repair it by the authorized repair center.
<ul style="list-style-type: none">• There's dust or dirt on the plug or socket.	Remove the dust or dirt.

Safety Precautions

To avoid personal injury and property loss, be sure to observe the following safety precautions.

- Meanings of the marks:

 Means "Forbidden" items	 General Forbid	 Disassemble Forbidden	 Wet hands Forbidden
	 Contact Forbidden	 Spray Water Forbidden	
 Means "Mandatory" items	 Must be executed	 Remove the power plug	

- The danger caused by mistaken use if following warnings are neglected includes to two grades.



Warning

It may possibly cause death or serious injury if the warning items are disobeyed.



Caution

It may cause physical injury or property damage if the caution items are disobeyed.

⚠ Warning

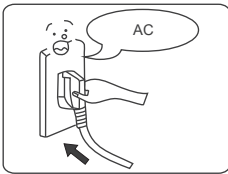

Use correct power outlet (Refer to the label)

- Failure to use correct electricity can cause fire or electric shock.
- Danger of fire if the bad socket is adopted.

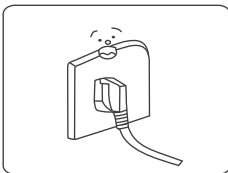

A socket shall be used alone

- A socket of more than 10A rated current with grounding wire shall be used alone;
- If shared with other electrical appliances, the socket may cause abnormal heat and result in fire.

Warning

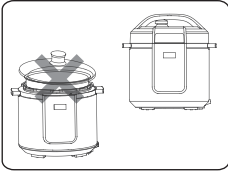

It is strictly prohibited to use other lid

- It is strictly prohibited to use other lid for heating, and in the (switching on) process, the use of non-original lid is not allowed.
- As this may cause electric shock or safety hazards.

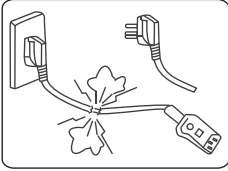

Stop using if the power cord is damaged

- Replace the damaged power cord with special soft cord or replace it with special assembly purchased from the manufacturer or authorized repair center.

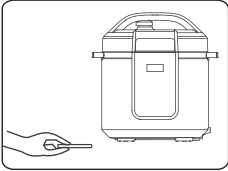

Do not put foreign objects

- It is prohibited to insert metal shavings, needles and other foreign matter in the gap.
- As this may cause electric shock or movement anomalies.

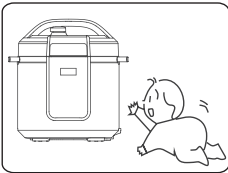

Place the appliance in a location out of reach of infants

- Place the appliance in a location out of reach of infants.
- To avoid electric shock and scald.

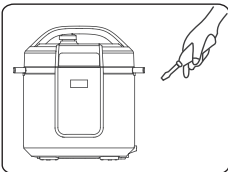

Modification is prohibited

- Modification or repair by non-professionals is prohibited.
- Violation may cause a fire or electric shock.
- Repair or replacement of parts shall be made in a designated service center.

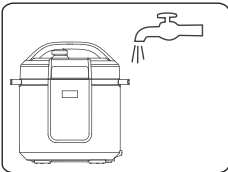

Products may not be immersed or sprinkled in water

- Doing so could cause electric shock and electrical short circuits.

⚠ Warning



Warning on Opening the lid

- When the electric pressure cooker is not working, there isn't pressure in the pot, the float valve is down;
- When the electric pressure cooker is working, pressure in the cooker rises, float valve ascends; do not fiercely open the lid before the pressure has been completely released;
- If it is difficult to open the lid, please do not open it fiercely, otherwise, it may cause scalding or physical injury.

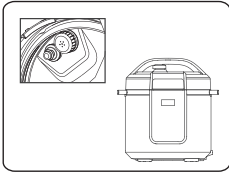

Check periodically

- Be sure to check periodically the block proof cover and exhaust valve core to make sure that they are not blocked;
- Do not cover the exhaust valve with heavy object or replace it with other object.

⚠ Caution

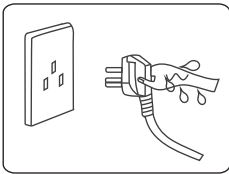

Never pull the plug with a wet hand

- To avoid electric shock.

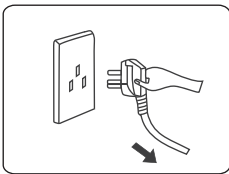

When pulling the plug, you must pinch the plug

- When pulling the plug, you must pinch the plug;
- Do not pull the power cord, otherwise it will damage the cord, causing electric shock and short circuit.

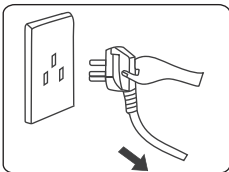

Unplugging when not in use

- Otherwise, it may produce leakage, fire or failure.

⚠ Caution

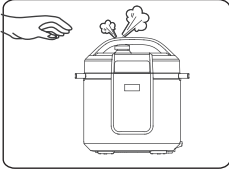

In working, never move your hands to close to the exhaust port.

- In cooking process, never move your hands to close to the exhaust port to avoid burns.
- During cooking, do not cover the vent with a cloth and other items.

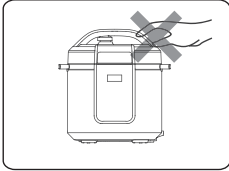

When the cooker is working, please do not touch the lid

- When the cooker is working, lid has high temperature, do not touch it;
- Otherwise, it may possibly cause scalding.

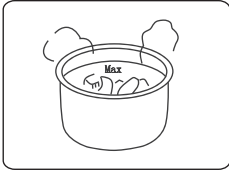

The total amount of food and water can not exceed Max scale

- The total amount of food and water can not exceed Max scale, otherwise food may be cooked unfamiliar, or cause malfunction.

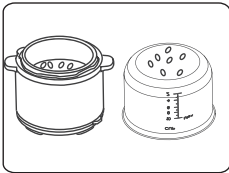

Do not use a pot other than the dedicated pot

- When there is foreign object on the bottom of pot and heating plate surface, remove the foreign object before use.
- Otherwise, it may cause overheating and work abnormalities etc.

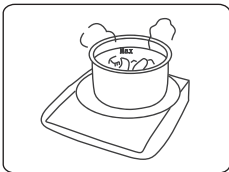

Do not put the inner pot on other appliance for heating

- In order to avoid deformation or fault.
- Please use the special inner pot.

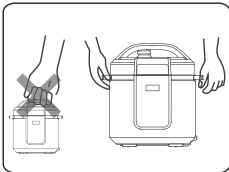

When moving the product, please hold the handle of cooker body

- When moving the product, do not directly hold the handle of lid for avoiding lid dropping.

Caution



Do not use in the following locations

- Do not use in unstable locations;
- Do not use in locations near water and fire;
- Do not use near walls and furniture;
- Do not use in locations exposed to direct sunlight and oil splatter.
- Do not approach the stove for avoiding fire.

Environment For Storing The Product

- Periodically clean the cooker and remove oil and dirt if it is stored on the table.
- Put the electric pressure cooker 30cm away from other kitchen appliances.

Clean After Use

1. Clean after each use.
2. Before cleaning and maintenance, please unplug the power cord until the product cools.
3. Remove the lid and inner pot, clean with detergent first, then rinse well with water, and wipe dry with a soft cloth.
4. Clean the internal side of the lid with water, the seal ring, block proof cover, exhaust valve core and float valve can be removed for washing, timely and correctly install them after washing, and then dry the internal side of lid with cloth.
5. Wipe clean the cooker body with a rag, and it is prohibited to soak the cooker body in water or spray water to it.

TROUBLESHOOTING

When followings occur, it is not the cooker fault, please carefully check once before sending it for repair.

S/N	Problem	Reason	Solution
1	Difficult to close the lid	• Sealing ring not installed properly.	• Position the sealing ring well.
		• The floater valve clamps the push rod.	• Lightly push the push rod.
2	Difficult to open the lid	• Float valve in the popped-up position.	• Press the float valve lightly with a chopstick.
		• Pressure exists inside the cooker.	• Open the lid after the pressure is completely released.
3	Steam leaks from the lid	• Sealing ring installed improperly.	• Install the sealing ring as required.
		• Food debris attached to the sealing ring.	• Clean the sealing ring.
		• Sealing ring damaged.	• Replace the sealing ring.
		• The lid is not closed correctly.	• Close the lid correctly.
4	Steam leaks from float valve.	• Food debris on the float valve gasket.	• Clean the float valve gasket.
		• Float valve gasket worn-out.	• Replace the float valve gasket.
5	Float valve unable to rise	• Too little food and water in inner pot.	• Add water and food according to the recipe.
		• Steam leaks from the lid or exhaust valve.	• Send to the service center for repair.

S/N	Problem	Reason	Solution
6	Steam comes out from exhaust valve non-stop	• Exhaust valve not in sealing position.	• Turn the exhaust valve to the sealing position.
		• Pressure control fails	• Send to the service center for repair.
7	Power indicator doesn't light on	• Power socket bad contact.	• Please check the power socket.
8	All indicators flas	• Bottom sensor fault.	• Send to the service center for repair.
			• Add water according to the requirement.
		• High temperature since there isn't water in the inner pot.	• Put the inner pot correctly.
			• Send to the service center for repair.
9	Rice half cooked or too hard	• Too little water.	• Add water accordingly.
		• Lid opened prematurely.	• After cooking cycle completes, leave the lid on for 5 more minutes.
10	Rice too soft	• Too much water.	• Reduce water accordingly.

—If the fault is not removed after above check, please contact our authorized service center for repair.

TRADEMARKS, COPYRIGHTS AND LEGAL STATEMENT

 Midea logo, word marks, trade name, trade dress and all versions there of are valuable assets of Midea Group and/or its affiliates (“Midea”), to which Midea owns trademarks, copyrights and other intellectual property rights, and all goodwill derived from using any part of an Midea trademark. Use of Midea trademark for commercial purposes without the prior written consent of Midea may constitute trademark infringement or unfair competition in violation of relevant laws.

This manual is created by Midea and Midea reserves all copyrights thereof. No entity or individual may use, duplicate, modify, distribute in whole or in part this manual, or bundle or sell with other products without the prior written consent of Midea.

All the described functions and instructions were up to date at the time of printing this manual. However, the actual product may vary due to improved functions and designs.

DISPOSAL AND RECYCLING

Important Instructions for Environment

Compliance with the WEEE Directive and Disposing of the Waster Product:
This product complies with EU WEEE Directive (2012/19/EU). This product bears a classification symbol for waster electrical and electronic equipment (WEEE).

This symbol indicates that this product shall not be disposed with other household wastes at the end of its service life. Used device must be returned to official collection point for recycling of electrical electronic devices. To find these collection systems please contact to your local authorities or retailer where the product was purchased. Each household performs important role in recovering and recycling of old appliance. Appropriate disposal of used appliance helps prevent potential negative consequences for the environment and human health.



Compliance with RoHS Directive

The product you have purchased complies with EU RoHS Directive (2011/65/EU). It does not contain harmful and prohibited materials specified in the Directive.

Package Information

Packaging materials of the product are manufactured from recyclable materials in accordance with our National Environment Regulations. Do not dispose of the packaging materials together with the domestic or other wastes. Take them to the packaging material collection points designated by the local authorities.



DATA PROTECTION NOTICE

For the provision of the services agreed with the customer, we agree to comply without restriction with all stipulations of applicable data protection law, in line with agreed countries within which services to the customer will be delivered, as well as, where applicable, the EU General Data Protection Regulation (GDPR).

Generally, our data processing is to fulfil our obligation under contract with you and for product safety reasons, to safeguard your rights in connection with warranty and product registration questions. In some cases, but only if appropriate data protection is ensured, personal data might be transferred to recipients located outside of the European Economic Area.

Further information are provided on request. You can contact our Data Protection Officer via **MideaDPO@midea.com**. To exercise your rights such as right to object your personal data being processed for direct marketing purposes, please contact us via **MideaDPO@midea.com**. To find further information, please follow the QR Code.

Midea

make yourself at home



www.midea.com

© Midea 2022 all rights reserved