

## Top Loading Water Dispenser

# Instruction Manual

MODEL: YLD1932S

Please read the manual carefully before operating your water dispenser. Retain it for future reference.

## A: SAFETY INSTRUCTION

1. This appliance can be used by children aged from 8 years and above and persons with reduced physical, sensory or mental capabilities or lack of experience and knowledge if they have been given supervision or instruction concerning use of the appliance in a safe way and understand the hazards involved. Children shall not play with the appliance. Cleaning and user maintenance shall not be made by children without supervision.
2. This appliance is intended, or for commercial use by lay persons.
3. If the supply cord is damaged, it must be replaced by the manufacturer, its service agent, or similarly qualified persons to avoid a hazard.
4. The appliance must not be cleaned by a water jet.
5. The appliance is suitable for indoor use only.
6. WARNING: Keep ventilation slots open, clear of any obstruction.
7. WARNING: Do not use mechanical devices or other means to accelerate the defrosting process, other than those recommended by the manufacturer.
8. WARNING: Do not use electrical appliances inside the food storage compartments of the appliance, unless they are of the type recommended by the manufacturer.
9. This product is not recommended at an altitude of 2,500 meters above the region to use.
10. Rated voltage: 220-240V /50/60Hz
11. When cleaning the product, do not disassemble the faucets.
  12. WARNING: When positioning the appliance, ensure the supply cord is not trapped or damaged.
  13. WARNING: Do not locate multiple portable socket-outlets or portable power supplies at the rear of the appliance.

## B: FUNCTION INTRODUCTION

1. It must be used indoor only.
2. WARNING: Do not damage the refrigerant circuit.
3. Do not store explosive substances such as aerosol cans with a flammable propellant in this appliance.

**C: PARTS NAME**

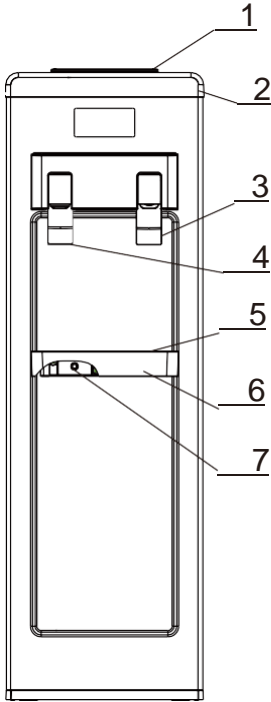

(FRONT)

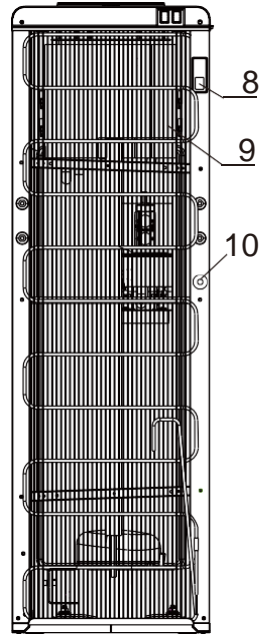

(REAR)

No.	PART NAME	No.	PART NAME
1	Bottle Supporter	6	Water Collector
2	Tap Cover	7	Water Outlet
3	Cold Water	8	Cooling Switch
4	Ambient Water	9	Condenser
5	Water Collector Cover	10	Power Supply Cord

**NOTE:**

This machine is suitable for bottles up to the size of 21L.

## E: OPERATION INSTRUCTION

1. Tear the label from the bottle.
2. Vertically insert the bottle into the bottle supporter on top of the machine. Do not plug the power cord or push the heating switch until water runs out from the tap of hot water.
3. Insert the plug to socket, then turn on the switch. Indicators light up accordingly once the machine works.
4. Vertically pull out the bottle by two hands when the bottle is empty, then replace it with another bottle of water.
5. This appliance should work under environment of temp. from 4-38 °C humidity ≤85 %
6. This appliance is not suitable for installation in an area where a water jet could be used.

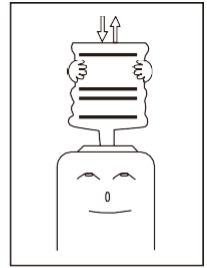

## F: CAUTION

1. Keep the machine in a dry place, avoid direct sunlight. Rear of the machine should be no more than 25cm against the wall. Never put the machine on paper or foam, which may cause unstable condition. Never put anything flammable beside this machine.
2. To avoid damage to the machine, don't plug the power cord or push the cool switch until water runs out from the tap of water.
3. To save power, unplug the machine and drain the remaining water through drain outlet, if it is not going to be used for long periods of time.
4. Avoid using harsh detergents when cleaning the machine.

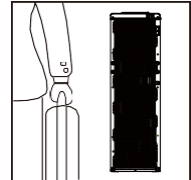
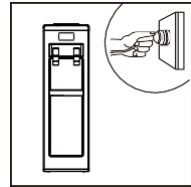
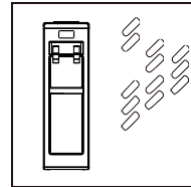

5. Never turn on (off) the machine by plugging the plug to (pulling the plug out from) the socket. Never increase the length of the power supply cord to avoid fire.

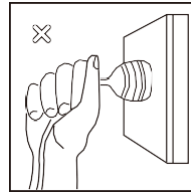

6. If the supply cord is damaged, it must be replaced by the manufacturer, its service agent or similarly qualified persons in order to avoid a hazard.

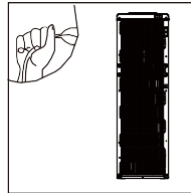

7. Never turn the machine upside-down or lean it more than 45°.

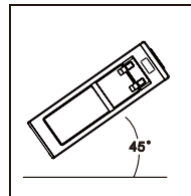

8. When the machine is under the ice point and blocked by ice, the cooling switch must be closed for 4 hours before turning it on again to continue its operation.

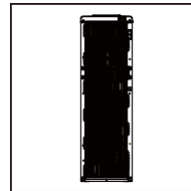

9. This machine should not be turned on until 3 minutes later after turning off the power switch.

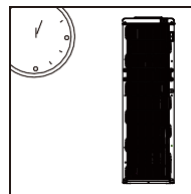

## G: TROUBLE SHOOTING

Please check the followings before having the machine repaired.

PROBLEMS	POSSIBLE CAUSES	ELIMINATION
No ambient or cold water	1. Over consumption of ambient or cold water in short time. 2. No power supply	1. Just wait a moment, then ambient or cold water is available again. 2. Connect plug to socket, turn on cooling switch.
No water running out from taps	1. Empty bottle 2. Inlet of bottle supporter blocked by bottle seal	1. Replace it with another one. 2. Clean out wasted paper & bottle seal, install bottle again
Leakage from bottle supporter	Broken bottle	Replace it with a new bottle
Noisy operation	Not placid installation	Place the machine on placid & solid surface

## H: CLEANING

To avoid accident, cut off the power supply before operation according to the following instruction.

1. The machine had been disinfected before departed from factory.

Cleaning the dispenser prior to installing a full bottle of water for the first time.

### 2. Cleaning and draining instruction:

- Before cleaning, make sure the power switch in the O(off) position and unplug the water dispenser.
- Vertically insert the bottle into the supporter on the top of the machine.
- Turn on all the taps in turn for 3 minutes after the water outflow, which completes the internal pipeline flushing.
- Removed the water bottle from the dispenser.
- Place a large bucket beneath the drain outlet. Remove the drain cover and allow water to drain.
- After cleaning, replace the drain cover and you can use the machine.

**Attention:** The dispenser heats water to a temperature of approximately 85 °C. It can cause severe burns. Please operate it carefully.

### 3. To remove mineral deposits:

Mix 4 Liters of water with 200g citric acid crystals, it would be best to put into an empty bottle to help flow through the taps, rinse with clean water two or three times. Generally, this should be done every six months.

Never disassemble this machine by yourself to avoid danger from damaged machine.

## I: MACHINE INSTALLATION

- 1-2. Loosen the screw of the left bottom angle just as the picture shown.
3. Use the screw to fix the bracket on the left bottom angle of the water dispenser.
4. Make a hole on the floor's or the desk's surface where the water dispenser will be installed.
5. Fix the bracket on the floor by screw tightly.

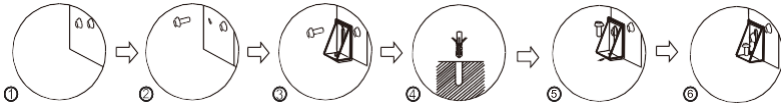
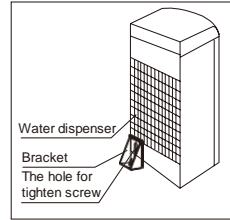

**WARNING!** To avoid a hazard due to instability of the appliance, it must be fixed in accordance with the instructions.

The packaging material used is recyclable; we recommend that you separate plastic, paper and cardboard and give them to recycling companies. To help preserve the environment, the refrigerant used in this product is R134a (Hydrofluorocarbon -HFC), which does not affect the ozone layer and has little impact on the greenhouse effect. According to WEEE (Waste of Electrical and Electronic Equipment) guidelines, waste from electrical and electronic devices should be collected separately. If you need to dispose of this appliance in the future, do NOT throw it away with the rest of your domestic garbage. Instead, please take the appliance to the nearest WEEE collection point, where available.



The product is subject to change without notice.  
Please keep this manual properly.

Foshan Shunde Midea Water Dispenser Manufacturing  
Company Limited

---

No.68 GuangLe Road, BEIJIAO, SHUNDE, FOSHAN, GUANGDONG,  
R.P.CHINA